



the  
ACCOMMODATION  
BUREAU

£795 Per Calendar Month

Westheath Avenue, Bodmin, PL31







## Property Description

A second floor two bedroom apartment in the former abbey.

This very well maintained apartment is finished to a high standard & is accessed via a communal hallway & stairs leading to the second floor. Inside the apartment, the front door leads into the hallway, lounge, kitchen/breakfast room with integrated gas hob, electric oven, washing machine, dishwasher & fridge/freezer.

There are two double bedrooms. The bathroom has an electric shower over the bath. Gas central heating.

Maintained communal gardens. 1 allocated parking space.

Energy Rating D (56). Council Tax Band B. Deposit £915. Sorry, no smokers, pets or sharers.

## Floorplan

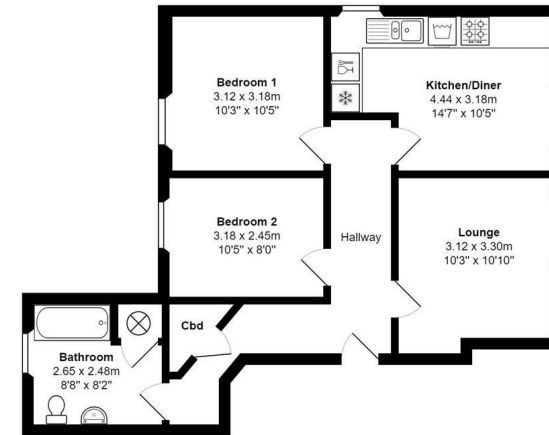

Total Area: 62.5 m<sup>2</sup> ... 673 ft<sup>2</sup>  
All measurements are approximate and for display purposes only

## Location

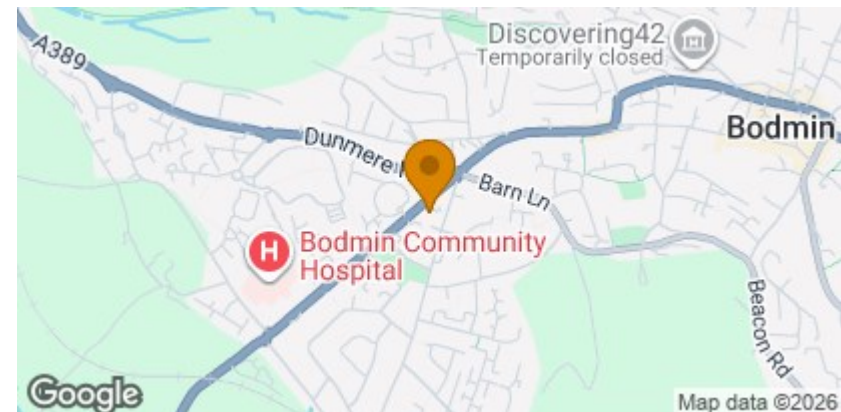

Features

- Historic Building
- Allocated Parking Space
- Kitchen With Appliances
- Gas Central Heating
- Energy Rating D
- Bathroom With Shower

Letting Information

Rent: £795 Per Calendar Month  
Holding Deposit: £100  
Total Deposit Required: £915  
Local Authority: Cornwall Council  
Council Tax Band: B  
Furnishing: Unfurnished  
Available From: 23rd February 2026

Energy Efficiency Rating

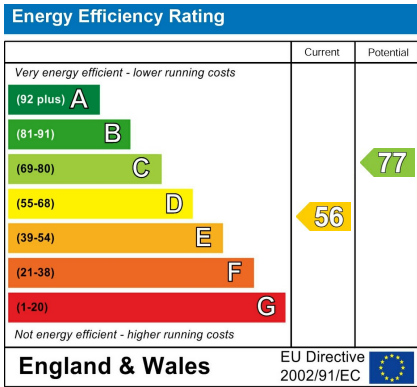

For further information, please call The Accommodation Bureau on 01208 78480.  
7 Turf Street, Bodmin, PL31 2DJ. [bodmin@theaccommodationbureau.com](mailto:bodmin@theaccommodationbureau.com).

These particulars, whilst believed to be accurate are set out as a general outline only for guidance and do not constitute any part of an offer or contract. Prospective tenants should not rely on them as statements of representation of fact, but must satisfy themselves by inspection or otherwise as to their accuracy. No person in this firms employment has the authority to make or give any representation or warranty in respect of the property.

